

BLOW PIPE RINGS

TABLE OF STANDARD SIZES CARRIED IN STOCK.
 PRICES ON APPLICATION.
 GALVANIZED ALSO AVAILABLE.

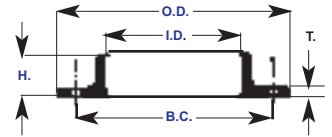

ORDER SIZE	ACTUAL INSIDE DIAMETER INCHES I.D.	OUTSIDE DIAMETER INCHES O.D.	THICKNESS INCHES T.	HEIGHT INCHES H.	BOLT CIRCLES, INCHES B.C.	HOLES		APPROX. WEIGHT LBS. EACH
						SIZE IN.	NUMBER	
3 Pressed	3 1/8	5 1/8	10 ga.	1	4 5/16	9/32	6	0.67
4 Pressed	4 1/8	6 1/8	10 ga.	1	5 5/16	9/32	6	0.88
4	4 1/8	6 1/8	1/8	1	5 1/4	9/32	4	1.00
5 Pressed	5 1/8	7 1/8	10 ga.	1	6 5/16	9/32	6	1.13
5	5 1/8	7 1/8	1/8	1	6 5/16	9/32	6	1.25
6	6 3/32	8 19/32	1/8	1 1/4	7 5/16	9/32	6	1.75
7	7 1/8	9 5/8	1/8	1 1/4	8 1/2	3/8	6	2.00
8	8 1/8	10 5/8	1/8	1 1/4	9 9/16	3/8	6	2.25
9	9 1/8	11 5/8	1/8	1 1/4	10 5/8	7/16	6	2.50
10	10 1/8	12 5/8	1/8	1 1/4	11 13/16	7/16	6	2.75
11	11 1/8	13 5/8	1/8	1 1/4	12 3/4	7/16	6	3.00
12	12 1/8	15 1/8	1/8	1 1/2	14	7/16	8	4.00
13	13 1/8	16 1/8	1/8	1 1/2	15	7/16	8	4.25
14	14 1/8	17 1/8	1/8	1 1/2	16	7/16	8	4.75
15	15 1/8	18 1/8	3/16	1 1/2	17	7/16	8	7.25
16	16 1/8	19 1/8	3/16	1 1/2	18	7/16	8	8.00
17	17 1/8	20 1/8	3/16	1 1/2	19	7/16	8	8.25
18	18 1/8	21 1/8	3/16	1 1/2	20	7/16	8	8.50
19	19 1/8	22 1/8	3/16	1 1/2	20 3/4	7/16	12	8.75
20	20 1/8	23 1/8	3/16	1 1/2	21 3/4	7/16	12	9.50
21	21 1/8	24 1/8	3/16	1 1/2	22 3/4	7/16	12	10.25
22	22 1/8	25 1/8	3/16	1 1/2	23 3/4	7/16	12	10.75
23	23 1/8	26 1/8	3/16	1 1/2	24 7/8	7/16	12	11.25
24	24 1/8	27 1/8	3/16	1 1/2	25 7/8	7/16	12	11.50
25	25 1/8	28 1/8	3/16	1 1/2	26 7/8	7/16	16	12.00
26	26 1/8	30 1/8	3/16	2	28 3/8	7/16	16	16.50
27	27 1/8	31 1/8	3/16	2	29 3/8	7/16	16	16.75
28	28 1/8	32 1/8	3/16	2	30 3/8	7/16	16	18.00
29	29 1/8	33 1/8	3/16	2	31 3/8	7/16	16	18.75
30	30 1/8	34 1/8	3/16	2	32 3/8	7/16	16	19.50
31	31 1/8	35 1/8	3/16	2	33 3/8	7/16	16	19.75
32	32 1/8	36 1/8	3/16	2	34 3/8	7/16	16	20.00
33	33 1/8	37 1/8	3/16	2	35 3/8	7/16	16	21.25
34	34 1/8	38 1/8	3/16	2	36 3/8	7/16	16	22.00
35	35 1/8	39 1/8	3/16	2	37 3/8	7/16	16	22.50
36	36 1/8	40 1/8	3/16	2	38 3/8	7/16	16	23.00
37	37 1/8	41 1/8	3/16	2	39 3/8	7/16	24	23.75
38	38 1/8	42 1/8	3/16	2	40 3/8	7/16	24	24.50
39	39 1/8	43 1/8	3/16	2	41 3/8	7/16	24	25.00
40	40 1/8	44 1/8	3/16	2	42 3/8	7/16	24	25.75
41	41 1/8	45 1/8	3/16	2	43 3/8	7/16	24	26.13
42	42 1/8	46 1/8	3/16	2	44 3/8	7/16	24	26.50
43	43 1/8	47 1/8	3/16	2	45 3/8	7/16	24	27.38
44	44 1/8	48 1/8	3/16	2	46 3/8	7/16	24	28.00
45	45 1/8	49 1/8	3/16	2	47 3/8	7/16	24	28.63
46	46 1/8	50 1/8	3/16	2	48 3/8	7/16	24	29.00
47	47 1/8	51 1/8	3/16	2	49 3/8	7/16	24	29.88
48	48 1/8	52 1/8	3/16	2	50 3/8	7/16	24	30.75
49	49 1/8	53 1/8	3/16	2	51 3/8	7/16	24	31.50
50	50 1/8	54 1/8	3/16	2	52 3/8	7/16	24	32.00